

STORETEQ F-100

Performance tailored to your needs.

Our single-axis feeder – the ideal addition
for panel dividing or nesting.

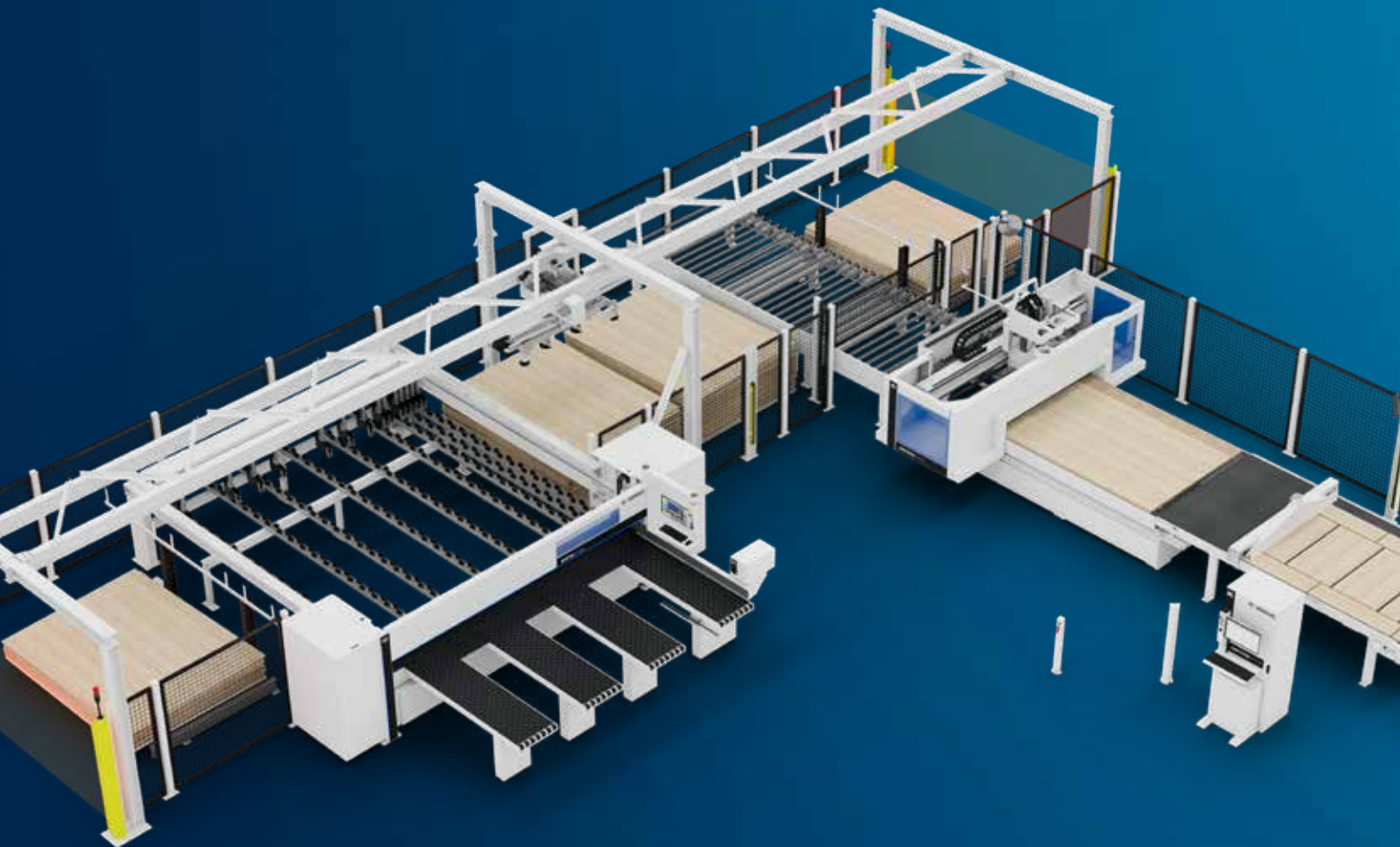



Intelligent loading combination. Save material. Save space.

Efficient, ergonomic, and gentle on material: The new HOMAG STORETEQ F-100 single-axis feeder is a winner right down the line – and with minimal space requirements. Control, including off-cut handling, is particularly intuitive and simple directly at the saw or the CNC machine via woodStore software.

The STORETEQ F-100 uses vacuum suction to fetch the next board just-in-time from the stacking area next to or behind the machine, rotates the material as needed, and places it in the saw or on the CNC machine. Everything is fully automatic.

YOUR SOLUTION

MORE AT HOMAG.COM



STORETEQ F-100

CONTENTS

- 04 STORETEQ F-100
- 06 Application examples
- 10 Control system
- 11 Software
- 12 Technical data
- 13 Service

Clever and variable

The STORETEQ F-100 provides even more efficiency and flexibility in panel dividing or nesting. Gentle on the material, automatic and fast. With its newly developed layout concept, the STORETEQ F-100 does not require any additional intermediate suspensions or cross bracing for a standard span of up to 12 m – for optimum space utilization in your production.

BASIC EQUIPMENT

- Basic frame in gantry design
- Movable lifting device with suction crossbeam
- Turning unit – rotatable up to 90 degrees
- Automatic weight detection
- Automatic length adjustment of the suction crosshead

ADDITIONAL EQUIPMENT

- Stacking positions available in 3,200 mm or 4,200 mm board length
- Additional storage places possible
- Expandable up to 8 stations, of which
 - maximum 3 processing machines
 - maximum 4 storage places
- Additional control panel for several integrated machines

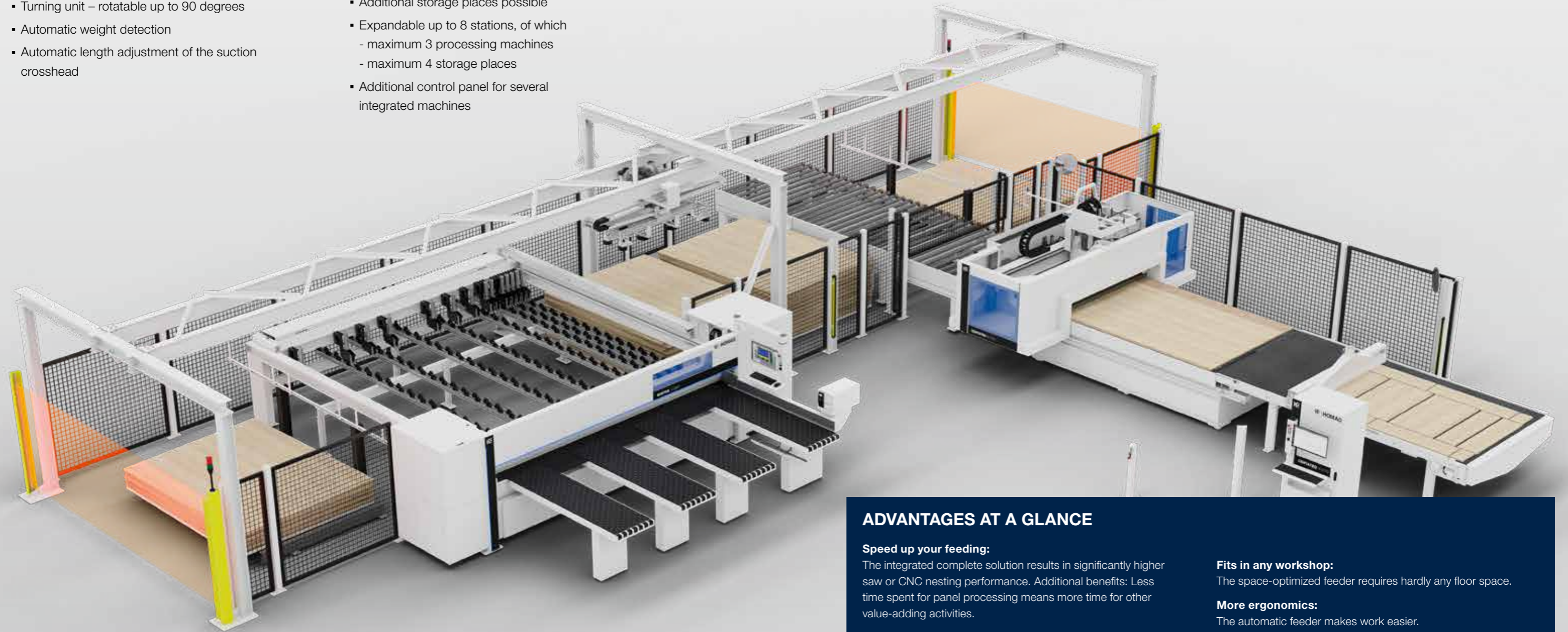

ADVANTAGES AT A GLANCE

Speed up your feeding:

The integrated complete solution results in significantly higher saw or CNC nesting performance. Additional benefits: Less time spent for panel processing means more time for other value-adding activities.

Fully automatic board handling:

A continuous process flow increases your productivity and saves time.

Gentle transport:

The single-axis feeder ensures your panel quality.

Fits in any workshop:

The space-optimized feeder requires hardly any floor space.

More ergonomics:

The automatic feeder makes work easier.

Standard interface:

All machines are already configured and ready to use – without additional service support.

Intuitive operation:

You operate the feeder conveniently via woodStore directly at the saw or CNC.

Application examples: STORETEQ F-100 with storage places in combination with an external storage system

The STORETEQ F-100 adapts individually to your processes and requirements in cutting. From the 2 series of saws and with the CENTATEQ N-210/510/600 and N-300/500, tailor-made layouts can be put together: With one or more machines and several stacking stations.

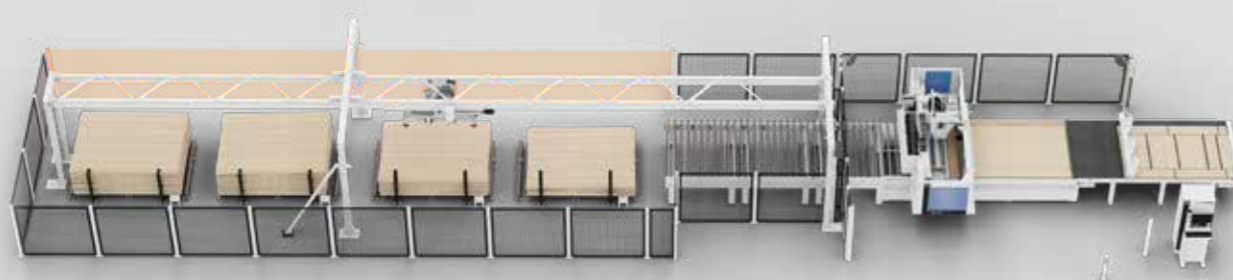
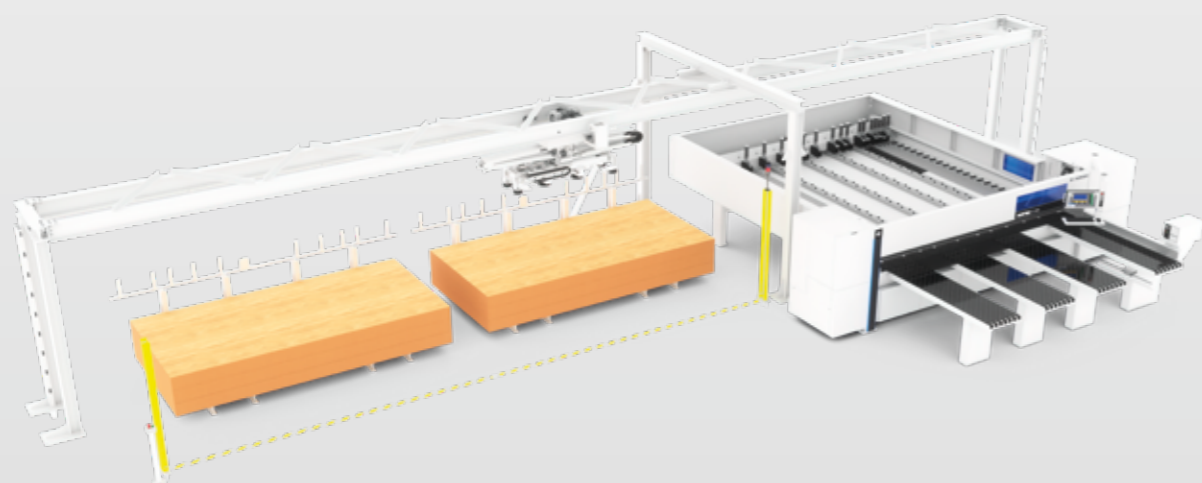

Stacks of panels come from outside and are placed on the storage locations of the STORETEQ F-100 by forklift. Production is started directly at the saw or the CNC processing center.

Advantages:

- Up to four storage locations enable the simple loading of
 - stacks of unmixed panels on a pallet directly from the external storage system, e.g. cantilever rack
 - of manually assembled, customer-specific stacks, e.g. of different materials or decors
- Automated loading process ensures high material throughput without interrupting production
- Ergonomic and material-friendly loading relieves the machine operator and increases quality

STORETEQ F-100 with putaway and storage locations in combination with an external warehouse

Stacks of panels come from outside and are placed in the storage locations of the STORETEQ F-100 by forklift. In addition, storage locations are available for frequently used materials (unmixed stacks, A-goods material), which are filled overnight from the storage location using a suction traverse, for example. Production is started directly at the saw or at the CNC processing center. Loading takes place both from the storage location and from the storage area.

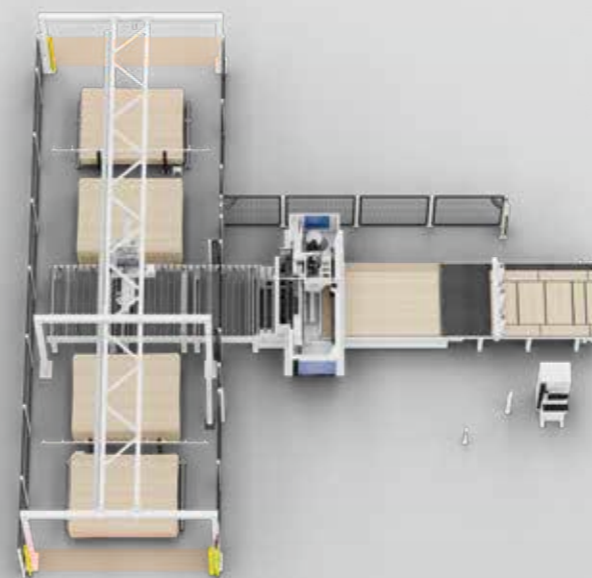
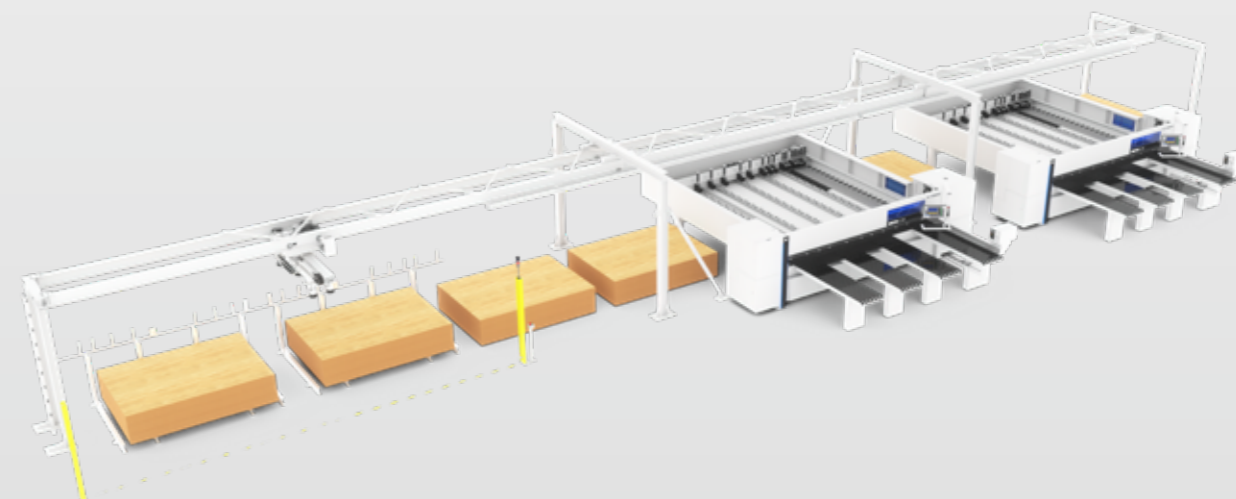

Advantages:

- Up to four storage locations enable the simple loading of
 - single-variety stacks of panels on a pallet directly from the external warehouse, e.g. cantilever rack
 - of manually assembled, customer-specific stacks, e.g. of different materials or decors
- Additional storage locations ensure increased material throughput without interrupting production
- Flexible production: loading takes place from both the storage area and the storage location, enabling even more efficient production
- Ergonomic and material-friendly loading relieves the machine operator and increases quality

STORETEQ F-100 as order picker with or without processing machine

Stacks of panels arrive from outside and are placed on the storage locations of the STORETEQ F-100 by forklift. A vacuum suction traverse transports the panels to another storage location where customer or order-specific stacks are formed. The stacks are then ready for production (for the variant with a processing machine) or can be taken to the customer (for the variant without a processing machine).

Important:

In the variant with a processing machine, the production sequence is the reverse of the picking sequence. In the variant without a processing machine, the storage bin can be used as the retrieval bin from which the picked stack is collected.

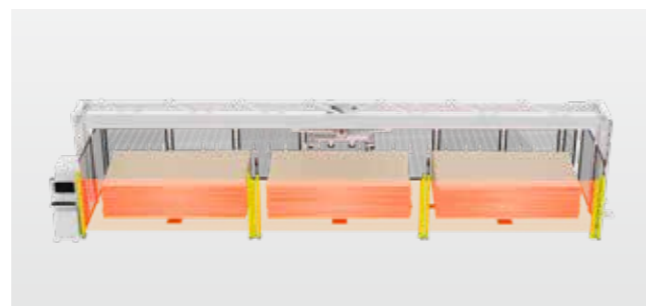
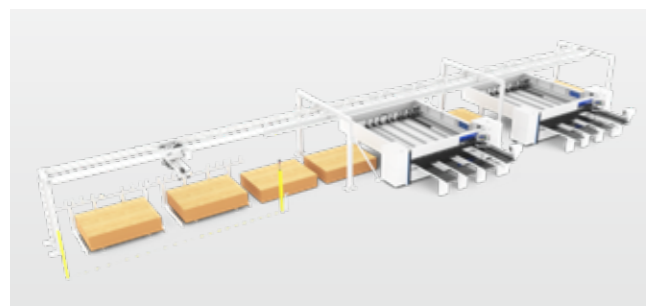
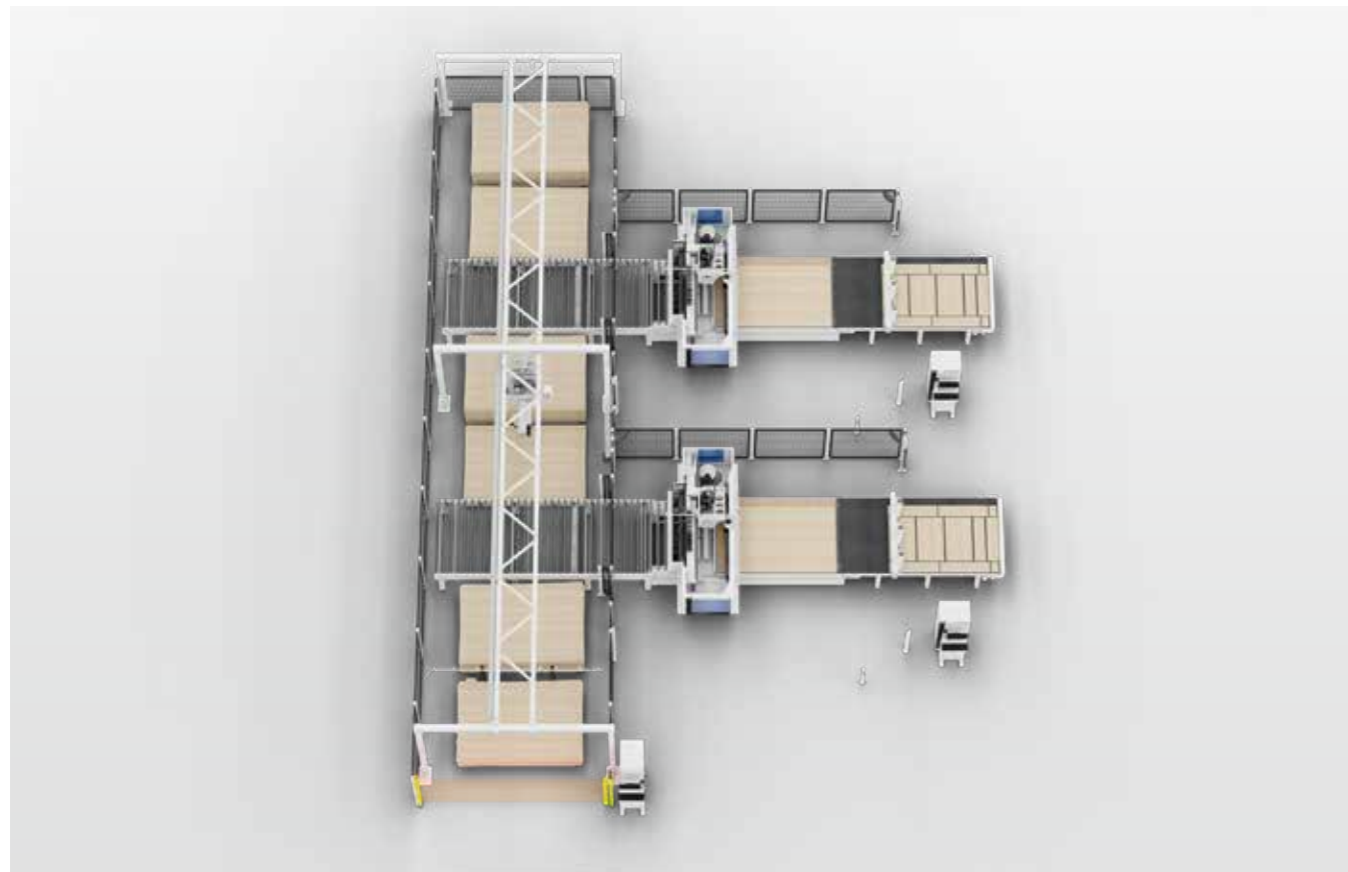

Automation: STORETEQ F-100 in conjunction with robot saw or for nest picking

As an automated cell, the STORETEQ F-100 single-axis feeder – as shown in application examples 1-3 – can also be equipped with storage and storage locations or serve as an order picker. The advantage of this application, however, is that the robot handling in all three examples means that the process is semi- or fully automated, from feeding to cutting or nesting.

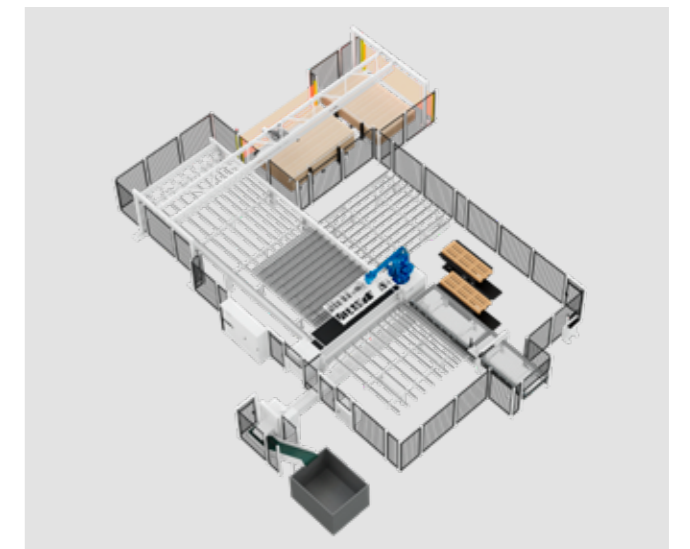

Advantages:

- Automation in the smallest space: Continuous process flow increases productivity and saves time
- Unmanned operation up to the stack change
- Number of storage locations required adapted to the available space, material variety and output
- Ergonomic and material-friendly panel handling relieves the machine operator and increases quality
- Standardized interfaces for simple data integration and processing-processing

Control system

Operation directly at the processing machine is particularly intuitive and simple with the standardized powerTouch control system from HOMAG. The advantage: In combination with a SAWTEQ or CENTATEQ from HOMAG, no additional operating terminal is required. The proven woodStore storage software runs in the background, ensuring smooth loading of the saw or nesting machine. In conjunction with the processing machine, this creates a complete production cell – including the management of manual off-cut and external storage.



Smart & flexibly scalable

The software of the STORETEQ F-100 single-axis feeder grows with your requirements and becomes more intelligent without the operator having to intervene in a time-consuming way. The simplest variant is to place the stack in the storage bin, give the start signal to the processing machine and you're ready to go.

Other highlights of the single-axis feeder:

- Manual off-cut management – Cost savings through optimum material utilization.
- Working with job lists – no manual input of stack information for even more efficient production
- Optimization data can be easily imported – due to the integration in the processing machine no additional data for the STORETEQ F-100 have to be generated.

Simple and intuitive operation

- Double-click on the storage bin and the storage starts
- Alternatively: "Fill stacks" via the Start editing menu

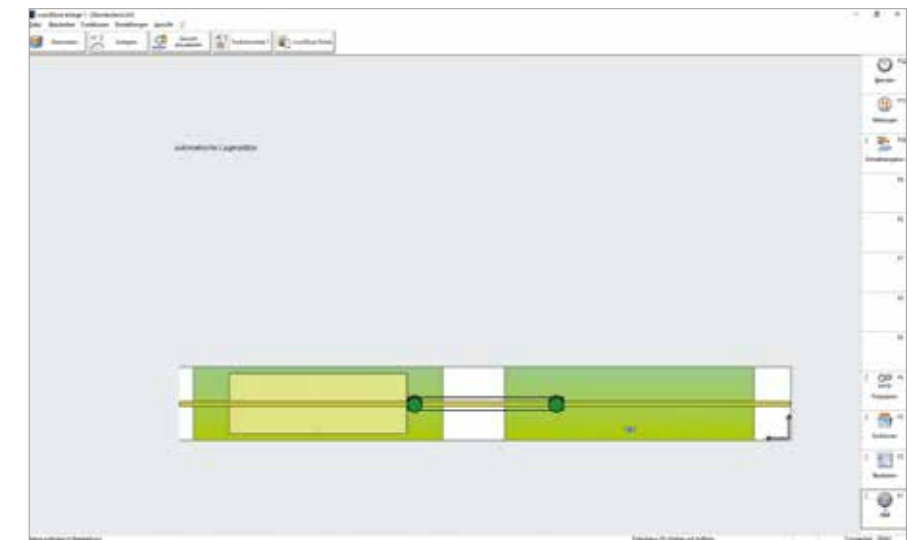

EVERYTHING UNDER CONTROL WITH MAXIMUM TRANSPARENCY

MMR basic

With MMR basic you get an overview of the performance of your STORETEQ F-100 – so you always have all the relevant machine information with you wherever you are.

MachineBoard

The MachineBoard clearly shows the remaining running times cycle of the STORETEQ F-100 for continuous tracking of your production. continuous tracking of your production.



TECHNICAL DATA

Model	STORETEQ F-100
Panel size stacking space	3,200 x 2,200 mm 4,200 x 2,200 mm To save even more space, the storage and stacking spaces are available in width (min. 2,800 mm) and depth (min. 1,500 mm).
Panel length	2,000 mm to 4,200 mm
Panel width	600 mm to 2,200 mm
Panel thickness coated	8 mm to 40 mm
Individual weight of panels	max. 250 kg
Stacking height	max. 1,800 mm (optionally 2,100 mm)
Carriage	80 m/min
Lifting drive	25 m/min

VALYOU

Our Mission, Your Performance.



Fast support:
94% resolution rate via our hotline

Close to you:
1,350 service experts worldwide

We get things moving:
Over 1,000 worldwide spare parts shipments each day

No one else has that:
Electronic documentation on over 150,000 machines, available in 28 languages

LIFE CYCLE SERVICES

Improved performance, more efficient processes, faster help, assurance of availability and smarter working.
VAL YOU comes from VALUE ADDED. Our objective is derived from this name: We create added value for your business by helping you get the most out of your processes. Every day.



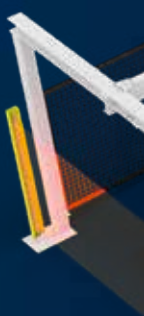

HOMAG Group AG

info@homag.com

www.homag.com

YOUR SOLUTION